



SUBMITTAL SHEET CPHH PUMP HOUSE CONVECTION HEATERS

Capacities
500 Watts
1,706 Btuh
120V, 240 V
Single Phase
Built-In Controls



JOB NAME: _____

LOCATION: _____

ARCHITECT: _____

ENGINEER: _____

CONTRACTOR: _____

SUBMITTED BY: _____

QUANTITY: _____ DATE: _____

QTY.	CATALOG NUMBER	TAG	HEATER			AMPS
			KW	VOLTS	Ø	

Electrical					Dimensions (In.)			Ordering			Wt. (lbs.)
kW	Volts	No. Elements	Amps	btuh	Height	Width	Depth	Model	Stock	PCN	
0.5	120	1	4.2	1,707	2-1/2	18-7/8	6-1/8	CPHH-50011	S	350190	5
0.375	208	1	1.8	1,280	2-1/2	18-7/8	6-1/8	CPHH-50031	S	350203	5
0.5	240	1	2.1	1,707	2-1/2	18-7/8	6-1/8	CPHH-50031	S	350203	5

SUGGESTED ENGINEERING SPECIFICATIONS

CONSTRUCTION

Enclosures shall be constructed of reinforced 18 gauge steel to withstand heavy-duty, commercial-institutional use. Grilles shall be closely spaced to restrict entry of foreign objects.

HEATING ELEMENT

Heating elements shall be steel sheath, enclosed, non-humming, fin-tubes, finished with high temperature corrosion resistant paint.

THERMAL PROTECTION

Thermal overheat protection shall be line voltage type with automatic reset to turn heating elements off should overheating occur. Operation shall automatically restore when cause for overheating is eliminated. Models with suffix M in the model number include an additional manual reset cutout.

CONTROLS

Heater to include an adjustable thermostat (40 - 100°F)

FINISH

Enclosure shall be chemically treated to resist corrosion and finished in Almond color powder coat paint.

Each heater shall be completely factory assembled, wired, tested and shipped as a single assembly to eliminate job-site confusion and loss of parts, and to speed installation.

All cabinet convectors and electrical accessories shall be ETL listed to UL and CSA standards.

Finish shall be corrosion and temperature resistant to retain appearance throughout years of usage.

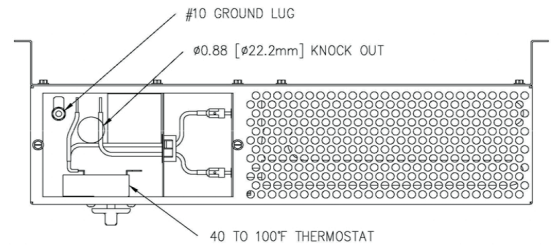
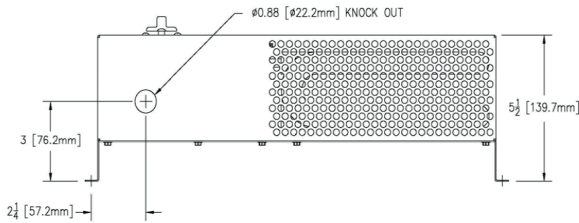
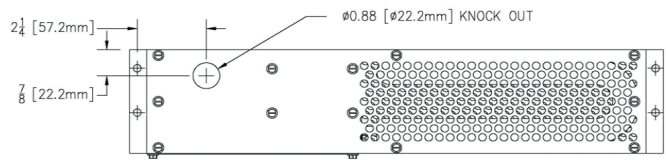
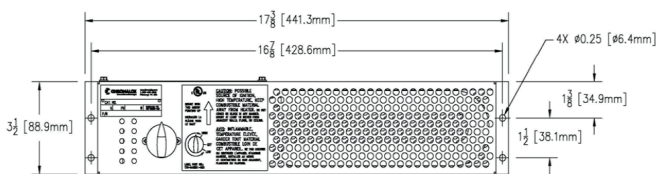

Limited Warranty:

Please refer to the Chromalox limited warranty applicable to this product at <http://www.chromalox.com/customer-service/policies/termsforsale.aspx>.

Chromalox, Inc.
1347 Heil Quaker Boulevard
Lavergne, TN 37086
(615) 793-3900
www.chromalox.com